

Dimension

Models U5215-930, U5221-930, U5223-930, U5223-940*, U5227-930, U5239-930

Ref. No.	Part No.	Description	Ref. No.	Part No.	Description
1	48663204	Upper Handle Assembly - ABE (Incl. items 2,3,4)	46	43576142	Motor Assembly Comp. -(P-202)
2	37911078	Handle Cap - ABE	47	36131090	Motor Retainer Cap -L.H.- ABE
3	N/A	Switch Rod - Upper	48	21447217	* Screw - Self Tapping - AY (5)
4	N/A	Switch Button	49	51669066	+ Hood Nameplate (19.5)
5	46388027	Attachment Cord Assem. AG 35 ft. -		51669070	Hood Nameplate (20.0)
6	4010100Z	Throw-Away Bag (3 Pk.)		51669075	Hood Nameplate - U5239-930
7	37257147	Tool Door- AAN	50	39383097	+ Dirt Finder Lens BZ
8	36433125	Tool Holder- ABE	51	42252298	Hood Assembly-ABM- U5215-930
9	38355008	Spring		42252292	Hood Assembly - ABB -U5221-930
10	36151013	Bag Door Latch - ABE		42252229	Hood Assembly - AAY- U5223-930
11	37255021	Hard Bag - ABE		42252364	Hood Assembly - ABR- U5227-930
12	38458046	Switch Rod Lever		42252A04	Hood Assembly - AG - U5239-930
13	39464025	Lower Handle - ABE	52	37257175	Air Intake Door Assembly - ABE
14	40201085	Handle Hardware Assembly	53	38351011	Spring
15	38634078	Extension Tube	54	38784056	+ Seal - AG
16	43414146	Dusting Brush Assembly - ABR	55	21362006	* Speed Nut
17	43434024	Hose Comp. - AB)(/AG	56	38613029	Air Intake - AG
18	32286025	Hose Adapter - Long - AG	57	51151004	Indicator Flag - BZ U5221-930, U5223-930, U5227-930
19	32377005	Hose Connector - AG	58	38733002	Bag Check Diaphragm - U5221-930, U5223-930, U5227-930
20	38614036	Furniture Nozzle - ABR			
21	38617026	Crevice Tool - ABR			
22	36433113	Lower Hose Support - ABE			
23	36425081	Bag Housing Bracket-ABE			
24	Note: All Bag Housing Doors include items 9 & 10				
	37257243	Bag Housing Door - ABM - U5215-930		21447220	* Screw (Tool Holder)
	37257212	Bag Housing Door ABB- U5221-930			
	37257213	Bag Housing Door AAY- U5223-930			
	37257214	+ Bag Housing Door ABR- U5227-930			
	37257242	Bag Housing Door AG - U5239-930			
25	38784016	Seal - AG			
26	38458022	Handle Release Lever - AG			
27	38567014	Indicator Knob - U5215-930			
		U5221-930, U5223-930, U5239-930			
	38567025	Indicator Knob - ABR - U5227-930			
28	38567009	Cam Actuator-AG			
29	31523012	Wheel Shaft - AG (2)			
30	38522011	Wheel - Rear-AG (2)			
31	42242266	Main Body Assem. - AG (Incl. items 26,29,30,44)			
		Cam Actuator Spring - FW			
32	34572002	Valve Gate - BZ			
33	38718005	* Wheel Retainer- AG (2)			
34	36131056	Wheel - AG - (2)			
35	38521023	Front Wheel Assembly			
	43248059	Wheel Support-ABE			
36	36432055	Front Wheel Assembly			
	43248059	Bottom Plate - AG			
37	37245108	Belt			
38	38528027	Agitator Assembly Complete - AG (P -204)			
39	48414081	Wheel Shaft - AY			
40	32563012	+ Lever - (Use wheel assem. 43248059)			
41	38452089	Nozzle Height Adv. Cam - BZ			
42	38563013	Spring - FW			
43	38351012	* Rug Nozzle Rib Shoe			
44	13261AY	Dirt Finder Lamp			
45	27313101				

ITEMS NOT ILLUSTRATED

21447220 * Screw (Tool Holder)

PACKAGING MATERIAL

56511A07 Owners Manual
58185184 Carton - Common
58369067 + Cleaner Support
58366099 Hard Bag Support

* Model U5223-940 is identical to the U5223-930 except for the addition of seven microfiltration bags.

Agitator - 48414081
 Agitator - 48414075

Elite/ Elite II/ Dimension/ Legacy/ TurboPOWER/ Caddy Vac - Four Brush
 Caddy Vac - Four Brush

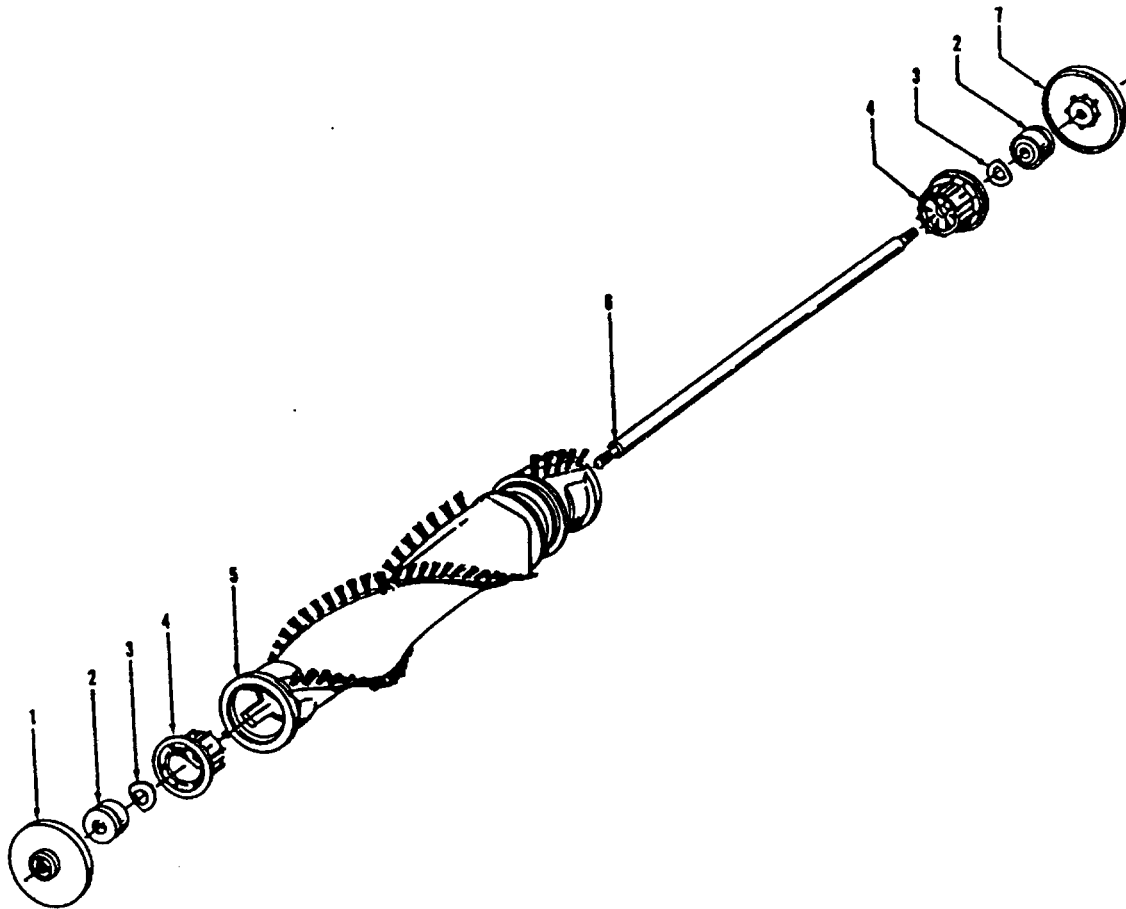

Ref. No.	Part No.	Description
	48414081	Agitator Assem. Complete (Natural Bristles)
	48414075	Agitator Assem. Complete (Blue Bristles)
1	36423016	Thread Guard - RH
2	43267002	Agitator Bearing Assem. (2)
3	21347003	Conical Washer (2)
4	36422022	Agitator End (2)
5	N/A	Agitator Body
6	32724013	+ Agitator Shaft
7	36423017	Thread Guard - LH - AG



Ref. No.	Part No.	Description
	43576142	Motor Assem. Comp.
	43576181	+ Motor Assem. Comp. (Replaced by 43576204)
1	214793DA	Screw-Self Tapping (4)
2	38736033	Fan Chamber
3	38755030	Fan
4	N/A	Rivet - Semi Tubular (2)
5	N/A	Motor Housing Assem.
6	N/A	Motor Brush Holder (2)
7	N/A	Motor Brush Assem. (2)
8	N/A	Bearing
9	N/A	Bearing Retainer
10	36914004	Switch Bus Bar
11	39116005	+ Attachment Terminal
12	28218043	Switch Assem. - Early Models (Prior to 5/96)
	28161062	Switch Assem. - Late Models (After 5/96)
13	N/A	Armature/Bearing Assem.
14	37194046	Motor End Cap Assem. - MW
15	N/A	Field Assem.
16	N/A	Lamp Holder Assem.
17	21312793	* Washer
18	38783020	Duct Seal
19	41311016	Motor Brush Holder Assem.

ITEMS NOT ILLUSTRATED

- 38781013 + Duct Seal (8 1/2" Long adhesive backed foam seal used on early models in place of item 18)
- 54821001 Tape (Roll)