

Elite

Models U4681, U4681-910

Ref. No.	Part No.	Description	Ref. No.	Part No.	Description
1	48663141	Upper Handle Assem. - MW	31	13261AY	* Rug Nozzle Rib Shoe
2	37911079	Handle Cap - ABE	32	42243001	Main Body Assem. (Incl. 12,13,16,31)
3	46388027	Attachment Cord - AG - 35 Ft.	33	38563012	Nozzle Height Adj. Cam
4	38335020	Bag Strap Spring - AY	34	38452089	+ Lever (Use wheel assem. 43248059)
5	36425072	Bag Strap - ABE	35	32563012	+ Wheel Shaft - AY (use 43248059)
6	36425064	Jacket Support - Upper - MW	36	43248059	Wheel - AG
7	43686083	Outer Bag - ABB (Incl. Items 6,1 1)	37	36131056	* Wheel Retainer
8	40201085	Nut & Bolt	38	48414081	Agitator (P. 204)
9	39464005	Lower Handle - MW	39	37245017	Bottom Plate
10	38456036	Switch Control Rod - AG	40	43248059	Front Wheel Support (Incl. It. 34, 35, 36)
11	36425063	Jacket Support - Lower - MW	41	34572002	Cam Actuator Spring
12	31523012	Rear Wheel Shaft	42	41426019	Tool Holder
13	38522011	Rear Wheel - AG	43	21447220	* Screw - Self Tapping
14	38567008	Cam Actuator - KE	44	43414145	Dusting Brush - Friction
15	38567014	Indicator Knob - ABB	45	43434033	Hose Comp.
16	38458022	Handle Release Lever	46	36116014	Hose Connector Collar - AG
17	38784016	Seal	47	32288011	Hose Adapter - AG
18	36131057	Motor Retainer Cap - R.H.	48	38656035	Hose Connector - AG
19	21447217	* Screw - Self Tapping	49	38614029	Furniture Nozzle - AAP
20	38351013	Spring	50	38617024	Crevice Tool
21	4010001A	Throw - Away Bag - 3 Pk.	51	38634078	Ext. Tube - AAP
22	37257018	Door Assem. - ABB (Incl. Items 23,24)	52	36433118	Tool Holder Connector
23	38785011	+ Seal	ITEMS NOT ILLUSTRATED		
24	21362006	* Speed Nut		3944201P	Cord Wrap
25	42252289	Hood Assem. - ABB (incl. Items 22,26)		56511353	Owner Manual
26	39383098	Dirt Finder Lens - KC		59185184	Carton
27	36131090	Motor Retainer Cap - L.H.		58346004	+ Front Support
28	43576142	Motor (P. 202)		58353009	Rear Support
29	27313101	Dirt Finder Lamp			
30	38528027	Belt			

Agitator - 48414081
 Agitator - 48414075

Elite/ Elite II/ Dimension/ Legacy/ TurboPOWER/ Caddy Vac - Four Brush
 Caddy Vac - Four Brush

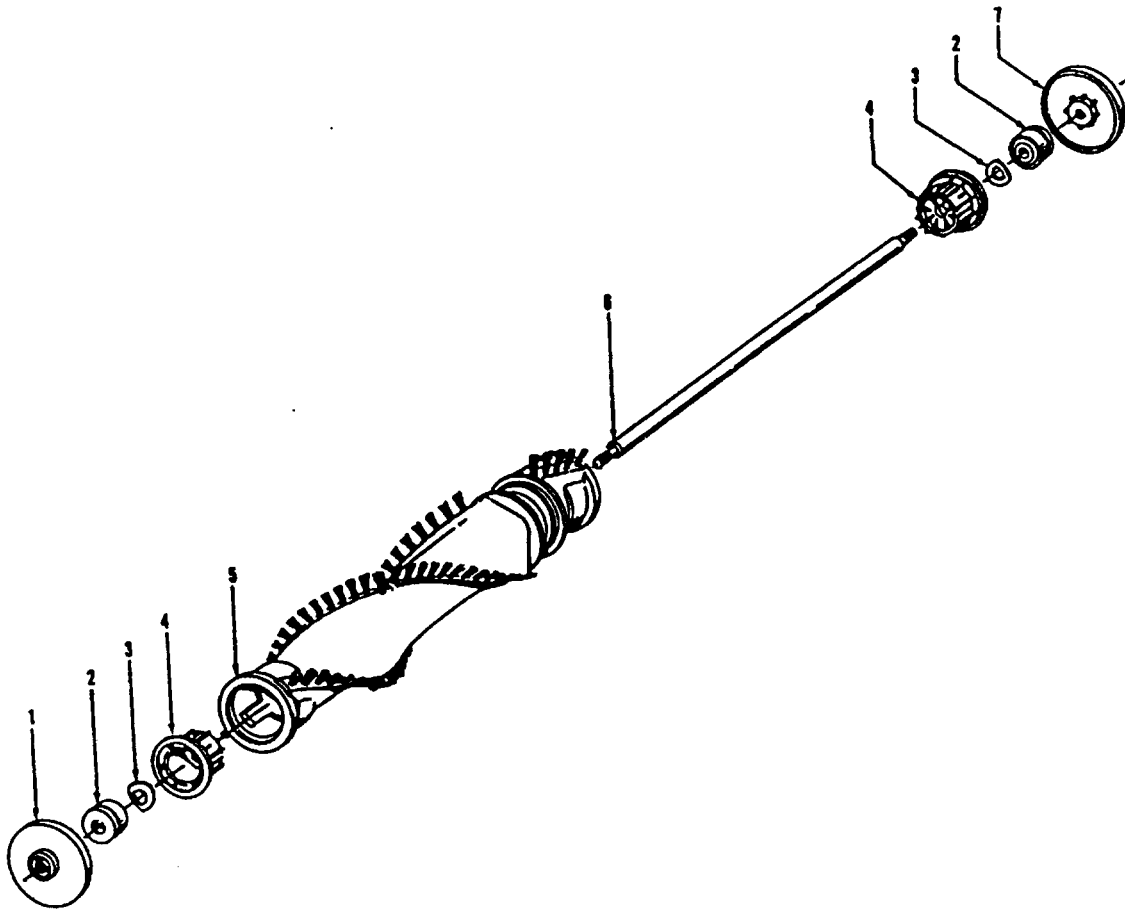

Ref. No.	Part No.	Description
	48414081	Agitator Assem. Complete (Natural Bristles)
	48414075	Agitator Assem. Complete (Blue Bristles)
1	36423016	Thread Guard - RH
2	43267002	Agitator Bearing Assem. (2)
3	21347003	Conical Washer (2)
4	36422022	Agitator End (2)
5	N/A	Agitator Body
6	32724013	+ Agitator Shaft
7	36423017	Thread Guard - LH - AG



Ref. No.	Part No.	Description
	43576142	Motor Assem. Comp.
	43576181	+ Motor Assem. Comp. (Replaced by 43576204)
1	214793DA	Screw-Self Tapping (4)
2	38736033	Fan Chamber
3	38755030	Fan
4	N/A	Rivet - Semi Tubular (2)
5	N/A	Motor Housing Assem.
6	N/A	Motor Brush Holder (2)
7	N/A	Motor Brush Assem. (2)
8	N/A	Bearing
9	N/A	Bearing Retainer
10	36914004	Switch Bus Bar
11	39116005	+ Attachment Terminal
12	28218043	Switch Assem. - Early Models (Prior to 5/96)
	28161062	Switch Assem. - Late Models (After 5/96)
13	N/A	Armature/Bearing Assem.
14	37194046	Motor End Cap Assem. - MW
15	N/A	Field Assem.
16	N/A	Lamp Holder Assem.
17	21312793	* Washer
18	38783020	Duct Seal
19	41311016	Motor Brush Holder Assem.

ITEMS NOT ILLUSTRATED

- 38781013 + Duct Seal (8 1/2" Long adhesive backed foam seal used on early models in place of item 18)
- 54821001 Tape (Roll)