

Legacy

Model U4569-910, U4581-910

Ref. No.	Part No.	Description
1	4010001A	Throw Away Bag (3 Pk.)
2	39458056	Handle Grip
3	38335020	Bag Strap Spring - AY
4	36425072	Bag Strap - MW
5	N/A	Cord Protector - MW
6	38456036	Switch Control Rod - AG
7	39464005	Lower Handle - MW
8	48663152	Upper Handle Assem. - MW
9	41426019	Tool Holder Assem. - MW
10	21447220	* Screw-Self Tapping
11	43414145	Dusting Brush - Friction
12	43434088	Cleaning Tool Hose Assem.
13	38614029	Furniture Nozzle - AG
14	38617024	Crevice Tool
15	38634078	Extension Tube - AAP
16	40201085	Nut & Bolt Assem.
17	36425063	Jacket Support - Lower - ABE
18	31523012	Wheel Shaft (2)
19	38522011	Wheel - Rear - AG (2)
20	34572002	Cam Actuator Spring - FW
21	38718005	Valve Gate - BZ
22	37245108	Bottom Plate - AG
23	36131056	* Wheel Retainer - BZ (2)
24	43248059	Wheel - AG
25	43248059	Front Wheel Assem. (Incl. It. 24, 28, 31)
26	48414081	Agitator Assem. Comp. - AG
27	38528027	Belt
28	38452089	+ Lever (use wheel assem. 43248059)
29	38563013	Nozzle Height Adj. Cam - BZ
30	38351012	Spring - AY
31	32563012	+ Wheel Shaft - AY (Use 43248059)
32	13261AY	* Rug Nozzle Rib Shoe
33	42242266	Main Body Assem. - AG (Incl. Items 18,19,32,37)
34	38567009	Cam Actuator - MW
35	43686125	Outer Bag Comp. - U4581-910 (Incl. Items 17,45,47)
	43686124	Outer Bag Comp. - U4569-910 (Incl. Items 17,45,47)
36	38567014	Indicator Knob
37	38458022	Handle Release Lever - AG
38	38784016	Seal - AG
39	27313101	Dirt Finder Lamp
40	43576142	Motor Assem.
41	40201085	Nut & Bolt Assem.
42	38613029	Air Intake - AG
43	36131090	Motor Retainer Cap - LH - MW
44	21447217	* Screw (5)
45	36425062	Jacket Support - Upper - ABE
46	21362006	* Speed Nut
47	37959076	Jacket Support Cap - ABE
48	38784056	+ Seal - AG
49	35111002	Drawer - AG
50	42252229	Hood Assem. - AAY - U4581-910
	42252226	Hood Assem. - ABA - U4569-910
51	42247005	Air Intake Door Assem. - AAY - U4581-910 (incl. Items 46,48)

Ref. No.	Part No.	Description
	42247004	+ Air Intake Door Assem. - ABA U4569-910 (Incl. Items 46,48)
52	38351011	Spring - AY
53	39383097	+ Dirt Finder Lens - BZ
54	46388027	Attachment Cord -AG - 35"
55	52115168	+ Hood Nameplate - U4581-910
	52115167	+ Hood Nameplate - U4569-91 0
56	32288011	Hose Adapter - AG
57	32377004	Hose Connector
58	36433118	Tool Holder Connector

ITEMS NOT ILLUSTRATED

3944201P	Cord Wrap
56511382	Owner Manual
58185184	Carton - Common
58385013	+ Cleaner Support
58347026	+ Carton
57363003	Air Freshener Tablets (4 Pk.)
48481059	+ Cleaning Tool Assem. (Incl. Items 11,12,13,14 and 58347026 Carton)

Agitator - 48414081
 Agitator - 48414075

Elite/ Elite II/ Dimension/ Legacy/ TurboPOWER/ Caddy Vac - Four Brush
 Caddy Vac - Four Brush

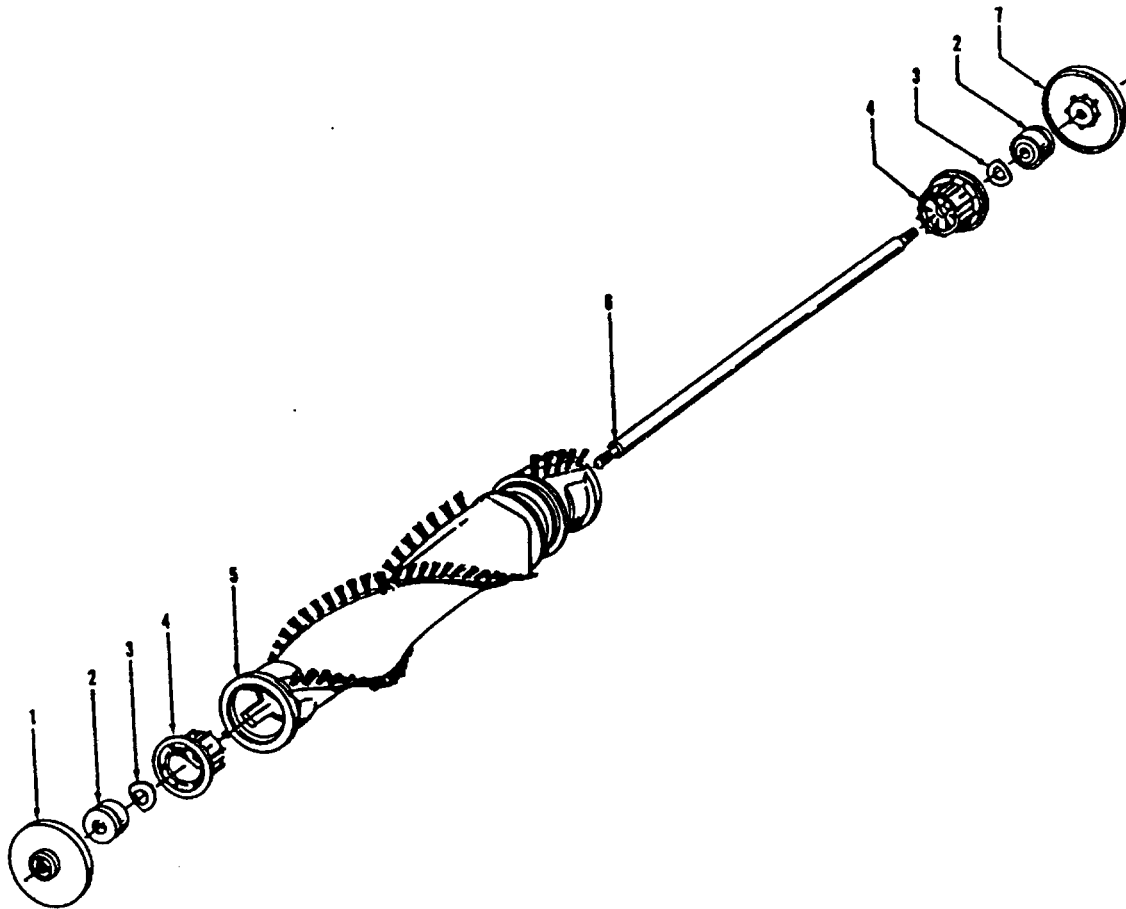

Ref. No.	Part No.	Description
	48414081	Agitator Assem. Complete (Natural Bristles)
	48414075	Agitator Assem. Complete (Blue Bristles)
1	36423016	Thread Guard - RH
2	43267002	Agitator Bearing Assem. (2)
3	21347003	Conical Washer (2)
4	36422022	Agitator End (2)
5	N/A	Agitator Body
6	32724013	+ Agitator Shaft
7	36423017	Thread Guard - LH - AG



Ref. No.	Part No.	Description
	43576142	Motor Assem. Comp.
	43576181	+ Motor Assem. Comp. (Replaced by 43576204)
1	214793DA	Screw-Self Tapping (4)
2	38736033	Fan Chamber
3	38755030	Fan
4	N/A	Rivet - Semi Tubular (2)
5	N/A	Motor Housing Assem.
6	N/A	Motor Brush Holder (2)
7	N/A	Motor Brush Assem. (2)
8	N/A	Bearing
9	N/A	Bearing Retainer
10	36914004	Switch Bus Bar
11	39116005	+ Attachment Terminal
12	28218043	Switch Assem. - Early Models (Prior to 5/96)
	28161062	Switch Assem. - Late Models (After 5/96)
13	N/A	Armature/Bearing Assem.
14	37194046	Motor End Cap Assem. - MW
15	N/A	Field Assem.
16	N/A	Lamp Holder Assem.
17	21312793	* Washer
18	38783020	Duct Seal
19	41311016	Motor Brush Holder Assem.

ITEMS NOT ILLUSTRATED

- 38781013 + Duct Seal (8 1/2" Long adhesive backed foam seal used on early models in place of item 18)
- 54821001 Tape (Roll)