



Ref. No.	Part No.	Description
1	162229 AG	Bag Door Assm - S1029
2	43662023	Bag Assm. Comp.
3	162064 LL +	Housing Assm. - R.H. - 404
	166982 DM +	Housing Assm. - R.H. - 409
	42222028	+ Housing Assm. - R.H. - JM
	42222030	+ Housing Assm. - R.H. - S1029
4	162062 AY	Hinge Pin (2)
5	162483	+ Nameplate - 404
6	34366001	Diffuser
7	162059 AG	Diffuser Door - 404, 409, S1029
	162059 DR +	Diffuser Door - 409
	162059 DS	Diffuser Door
	162059 JX +	Diffuser Door - S1029
8	48969	* Solderless Connector (2)
9	36215030	Cord Protector
10	162066	+ Housing Muffler (2)
11	12062	+ Lead Wire Assm. - Black
12	162075	+ Lead Wire Assm. - Yellow
13	162074	+ Lead Wire Assm. - White
14	12031	Motor Brush Assm. (2)
15	12971	Switch
16	12029	Motor Brush Holder (2)
17	162083 JM	Secondary Filter
18	163434	Pressure Pad (3)
19	12022	Field Lamination Bolt (2)
20	21312701	* Washer (2)
21	21447028	* Screw - Self Tapping (2)
22	12033	Motor Brush Retainer (2)
23	12059	Motor Brush Housing Assm.
24	12854	Compression Spring (2)
25	12007	* Pin (3)
26	21651037	* Nut - Special (2)
27	46363271	Attach. Cord Assm.
28	21312700	Washer (3)
29	43566003	Fan Assm. (2)
30	12000	Fan Nut
31		Not Applicable
32	12038	+ Motor End Cap Assm.
33	12089	Motor Mount - R.H.

Ref. No.	Part No.	Description
34	18656	Interstage Housing
35	170055	+ Fan Spacer
36	12003	Fan Spacer
37	167673	Armature Assm. Comp.
38	12050	Motor Casing
39	167677	Field Assm. Comp.
40	12013	Spacer
41	43566005	Fan
42	12028	Nut
43	163426	Outerstage Housing Assm.
44	163546	Retaining Ring
45	161957	Motor Seal Mount
46	162065 LL +	Housing Assm. - L.H. - 404
	162065 DM	Housing Assm. - L.H. - 409
	37223057	+ Housing Assm. - L.H.
47	21447043	* Screw - Self Tapping (2)
48	21479573	Screw - Self Tapping (4)
49	162060 AW ++	Tool Holder

## ITEMS NOT ILLUSTRATED

27482227	Strain Relief Bushing (Used on Item 27, Model 404)
160356	* Terminal (Used on Item 13)
161350	* Terminal (Used on Item 13)
160532	Terminal (Used on Item 11 & 12)

## PACKAGING MATERIAL

58152062	+ Carton - Portapower w/o Dolly
58172001	Carton - S1029
56512065	+ Owner Manual - S1015-030, 031, 032, 033, S1029

## WHEELED DOLLY

160017	* Retaining Ring
169242	Wheel Cover
43247006	Wheel (Includes Tire)
43248010	+ Dolly Comp.

# Cleaning Tools & Hose

Models 404, 409, S1015, S1015-030, S1015-031, S1015-032,  
S1015-033, S1015-075, S1029, S1029-075, S1049, S1049-022,  
S1055, S1075, S1077, S1077-033, S1079

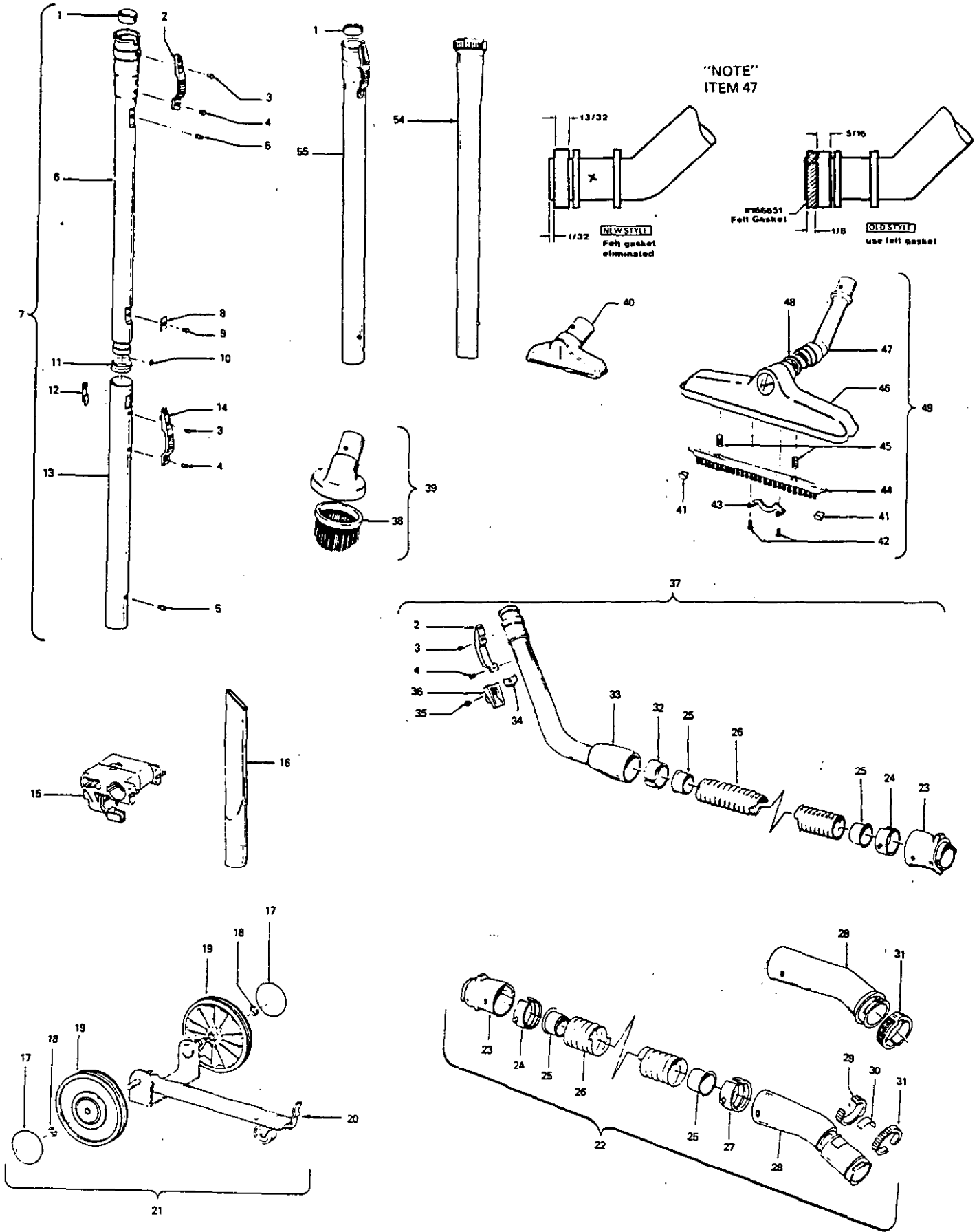

55

# Cleaning Tools & Hose

# Models 404, 409, S1015, S1015-030, S1015-031, S1015-032, S1015-033, S1015-075, S1029, S1029-075, S1049, S1049-022, S1055, S1075, S1077, S1077-033, S1079

Ref. No.	Part No.	Description
1	12845 JM	Gasket - 404, 409, S1015
2	12846 AG	Tube Latch - 404, 409, S1015
3	12772 --	+ Rivet (3) - 404, 409, S1015
4	12783 --	+ Rivet (3) - 404, 409, S1015
5	12763 AW	* Rivet (2) - 404, 409, S1015
6	12598 --	Ext. Tube Assm. - Inner - 404, 409, S1015
7	43458001	Ext. Tube Assm. Comp. - 404, 409, S1015
8	12824 --	+ Reinforcement Plate - 404, 409, S1015
9	12600 --	* Rivet - 404, 409, S1015
10	21312704 --	Washer - 404, 409, S1015
11	12844 JM	+ Gasket - Inner - 404, 409, S1015
12	12589 --	Ext. Tube Guide - 404, 409, S1015
13	12597 --	Ext. Tube Assm. - Outer 404, 409, S1015
14	36152018	Tube Latch - Outer - 404, 409, S1015
15	36433020	Tool Storage Rack - S1015-032, S1029, S1029-075, S1077, S1077-033, S1079
16	38617018	Crevice Tool
17	169242 --	Wheel Cover - S1029, S1029-075, S1077
18	160017 --	* Retaining Ring - S1029, S1029-075, S1077
19	43247006	Wheel (Incl. Tire) - S1029, S1029-075
	43247003	Wheel (Includes Tire) - S1077
20	43248005	+ Dolly Bracket (Incl. Caster Wheel) - S1029, S1029-075
21	43248010	+ Dolly Comp. - S1029, S1029-075
	43248011	Dolly Comp. - S1077
22	43434223	Hose Assm. Comp.
23	12593 JM	Hose Connector
	38656005	Hose Connector - S1075, S1077
24	12615 BZ	Hose Connector Collar
	38671011	Hose Connector Collar - S1075, S1077
25	32156010	Hose Sleeve (2)
26	43434213	Hose Less Ends
	38671001	Hose Less Ends - Blow Molded - S1075, S1077
27	36116006	Hose Connector Collar - S1015-030, 031, 032, 033, 075; S1029, S1029-075, S1049, S1049-022, S1055, S1079
	36171025	Hose Connector - Collar - S1075, S1077
28	43466044	Hose Connector Curved w/Rings - S1015-030, 031, 032, 033, 075;

Ref. No.	Part No.	Description
		S1029, S1029-075, S1049, S1049-022, S1055, S1079
	43466044	Hose Grip Assm. - S1075, S1077
29	38711006	Suction Control Ring - S1015-030, 031, 032, 033, 075; S1029, S1029-075, S1049, S1049-022, S1055, S1079
30	51869006	Hose Connector Label - S1015-030, 031, 032, 033, 075; S1029, S1029-075, S1049, S1049-022, S1055, S1079
31	36153021	Latch Ring - S1015-030, 031, 032, 033, 075; S1029, S1029-075, S1049, S1049-022, S1055, S1075, S1077, S1079
32	12704 BZ	Hose Grip Collar - 404, 409, S1015
33	43468019	Hose Tube Assm. - 404, 409, S1015
34	13257 BZ	Suction Regulator Support - 404, 409, S1015
35	13275 --	* Machine Screw - 404, 409, S1015
36	38421048	Suction Regulator - 404, 409, S1015
38	13263 BZ	+ Brush (Use w/161851JM)
39	43414064	Dusting Brush (One Piece)
40	43414057	Furniture Nozzle Assm. - AG
	38614024	Furniture Nozzle - AG - S1077, S1077-033
41	166646 --	Brush Retainer Clip
42	166648 AW	* Screw - Self Tapping (2)
43	166650 AY	Nozzle Tube Clamp
44	166656 --	Brush Back Assm.
45	166649 FW	Spring (2)
46	166763 DM	+ Nozzle & Lock Assm. - 404, 409
	43414089	Nozzle & Lock Assm.
47	166652 JM	Nozzle Tube Comp. (See Note)
48	166651 --	Gasket (Felt)
49	43414151	Rug & Floor Nozzle Assm.
54	38638044	Extension Tube - Poly - AG
55	43453027	Extension Tube

### ITEMS NOT ILLUSTRATED

58544004	+ Cleaning Tool Bag
170110 --	Shag Rake
161852 JM	+ Furniture Brush
633217 A	+ Rug & Floor Nozzle Assm. - 404
43414016	Furniture Brush - AG