

Shell

Models 82, 84, 84B, 85, 86, 87, 88, 434 444, 454, 843, 845, 858

Ref. No.	Part No.	Description	Ref. No.	Part No.	Description
1	23155JM	+ Handle 86, 87, 88, 434, 843, 845, 858	27	22967	+ Gasket - 82, 84, 85
	13981A	+ Handle - 82, 84, 84B, 85	28	48725	Secondary Filter Retainer
2	12738	+* Screw - 86, 87, 88, 434, 843, 850	29	34656	Secondary Filter
	47728	+* Handle Pin - 82, 84, 84B, 85	30	23058	+ Base - 82, 84, 85
3	47938	* Hinge Pin	31	162341	+* Rivet
4	34739A	+ Body Hinge Leaf - Upper	32	18154	+* Nut - 82, 84, 85
	48123AV	+* Lock Ring	33	19772	* Washer - 82, 84, 85
6	162345	+* Rivet	34	21772501	* Screw - 82, 84, 85
7	34842	+ Handle Bracket - 82, 84, 84B, 85	35	19251	+* Rivet
8	12330	Bag Sealing Collar	36	35532	+ Tool Holder Supt. Latch - 88, 434
9	23208A	+ Upper Shell - 86, 88, 434, 444	37	19574	+ Patent Plate - 843
	23208CD	+ Upper Shell - 843, 845		164021	+ Data Plate - 858
	23208KK	+ Upper Shell - 858	38	162345	+* Rivet
	23331S	+ Upper Shell - 87	39	34620	+ Shell Cover Latch Bracket
10	48608	+ Cord Retainer & Nut	40	18385	+* Rivet
11	48654	+ Screw for Switch Plate - 87	41	16439JX	+ Latch
12	23209	+ Nameplate - 86	42	48512FW	+ Spring
	23197	+ Nameplate - 87	43	34655	+ Motor Mount Retainer
13	47778A	Shell Cover Latch Hook	44	12226	+ Strain Relief Bushing
14	16576	+ Nameplate - 843, 850	46	4010010J	Throw Away Bag (4 - Pk.)
15	12783	+* Rivet	46	12626	+* Switch Nut - Round
16	34672	+ Medallion - 82, 84, 84B	47	12560	* Switch Nut - Hex
17	22997JM	+ Furniture Guard	48	16444A	+ Shell Body & Base - 86, 87, 88, 434, 454
18	11782DM	+ Cover Plate		19567DM	+ Shell Body & Base - 843
19	46875	* Screw		164060DM	+ Shell Body & Base - 858
20	23426	+ Cleaning Tool Holder Bracket	49	34740A	+ Body Hinge Leaf - Lower - 86, 87, 88, 434, 454
21	49434	+* Screw		34740LL	+ Body Hinge Leaf - Lower - 843, 858
22	11940A	+ Tool Holder - 88, 434	50	13312	Switch Clip
	11940LL	+ Tool Holder - 843	51	13313	Switch Clip
	23003A	+ Tool Holder - 82, 84, 85	52	12971	Switch
23	47826	+ Latch Hook - 82, 84, 85	53	12876	Switch for Round Hole
24	162339	+* Grommet - 82, 84, 85			
25	34861	+ Base Latch - 82, 84, 85			
26	162341	+* Rivet			

Motor

Models 82, 84, 84B, 85, 86, 87, 88, 434 444, 454, 843, 845, 858

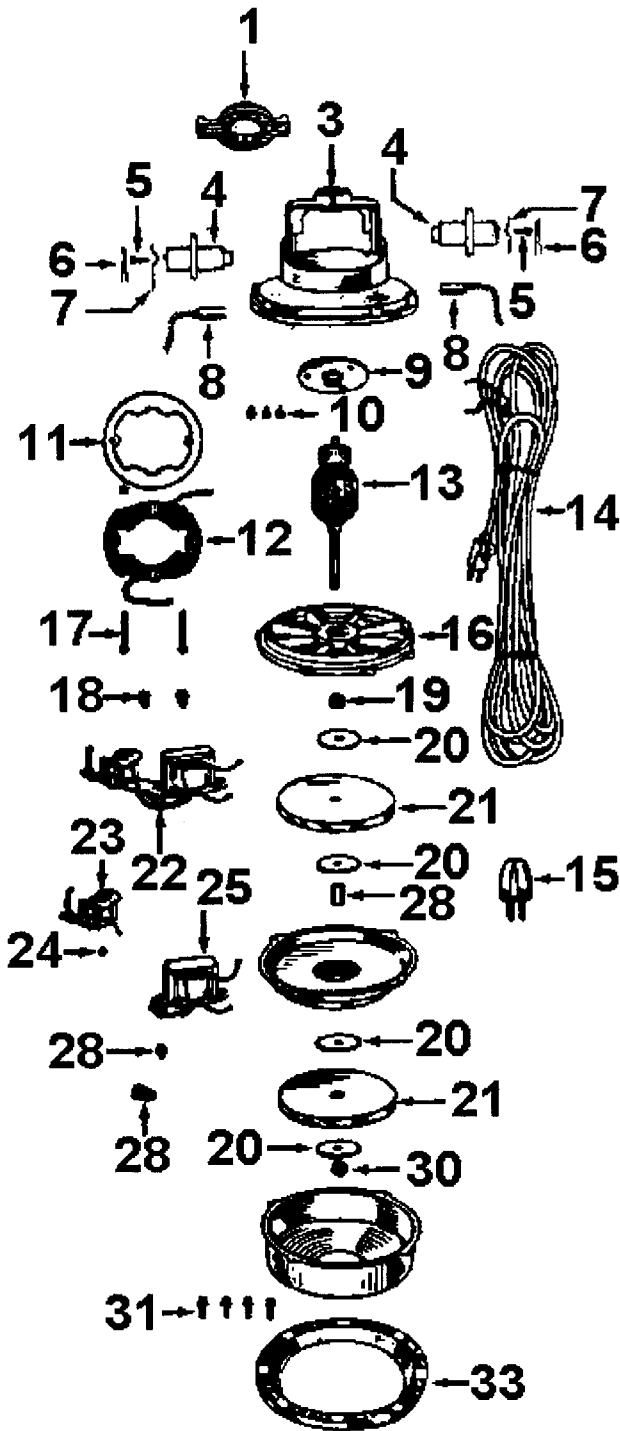

Ref. No.	Part No.	Description
	11185	+ Motor Comp. - 110V - Except 87
	48503	+ Motor Comp. - 220V - Except 87
1	34622	+ Rubber Mount
2	35335	+ Air Baffle - 87
3	10695	+ Motor Casing
4	18218AG	+ Motor Brush Holder
	48983	+ Motor Brush Holder - 87
5	46875	* Screw
6	18220	+* Cotter Pin
7	18219	+* Retainer
8	46100	Motor Brush
9	15856	+ Upper Bearing
10	44551	+* Screw
11	34737	+ Baffle
12	22938	+ Field Coil (110V)
13	22956	Armature (110V)
14	46363195	Cord
15	35380	Service Plug
16	34524	+ Bottom Bearing
17	15801	+* Screw
18	160356	* Terminals
19	163059	+* Fan Spacer
20	21312701	* Fan Spacer Washer
21	34511	+ Fan
22	23173	+ Transformer & Relay - 87
23	49115	+ Relay - 87
24	18154	+* Nut
25	48709	+ Transformer - 87
26	31732003	Fan Spacer - Long
27	34509	+ Deflector
28	48963	+* Screw - 87
29	48969	* Solderless Connector
30	18757	+* Nut
31	46877	+* Screw
32	22742AY	+ Fan Housing
33	22116	+ Rubber Mount

Cleaning Tools

Models 82, 84, 84B, 85

Ref. No.	Part No.	Description	Ref. No.	Part No.	Description
1	48163	+ Bracket	44	162342	+ Nut - 82
2	162345	+* Rivet	45	34718	+ Rug Nozzle Lifter Picker Clamp - 82
3	48160	+ Retaining Spring	46	34717	+ Rug Nozzle Lifter Picker - 82
4	3499T	+ Carriage Roller	47	47560	+ Rug Nozzle Swivel & Collar - 82
5	48159	+* Lock Ring	48	162313	+* Gasket
6	48149	+ Carriage Roller Axle	49	34167	+ Nozzle Brush
7	48402	+ Nozzle Hose	50	162312	+ Rug Nozzle Brush Spring
8	48166	+ Support Spring - R.H.	51	21465314	* Screw
9	162331	+ Rivet	52	12845JM	Gasket - Outer
10	48167	+ Support Spring - L.H.	53	48460	+* Rivet
11	17207AZ	* Lock Ring	54	12763AW	* Rivet
12	48148	+ Wheel Axle	55	35015	+ Lock Ring
13	48160	+ Retaining Spring	56	48467	+* Lock Pin
14	160548	+* Screw	57	35014	+* Tube Lock
15	32175003	Caster Wheel	58	12844JM	+ Outside Gasket - Inner Tube
16	43414101	+ Rug & Floor Nozzle Comp. - AAP	59	48468	+ Extension Tube Assm. - Outer
17	47041	+ Nozzle Lip & Gasket	60	34986LL	+ Extension Tube - Inner
18	55074	+ Nozzle Gasket	61		+ Extension Tube Comp. - (Use 43458001)
19	13275	+* Screw	62	43458001	Extension Wand
20	34167	Nozzle Brush	63	13077JM	+ Bare Floor Brush - 82
21	34450PH	+ Litter Picker		43414073	Floor Brush Assm.
22	162312	+ Rug Nozzle Brush Spring	64	13155JM	+ Bare Floor Brush Nozzle - 82 - (Use w/13077JM)
23	11622A	+ Nozzle Guard			
24	11443	+ Nozzle Casting	65	13253AG	+ Floor Brush Face - 82
25	162340	+* Rivet	66	13154JM	+ Floor Brush Swivel & Collar - 82 - (Use w/13077JM)
26	34667	+ Hose Latch Spring		38644040	Swivel Connector - (Use w/48473025)
27	23393JM	Hose Grip	67	13276	Swivel Bushings - 82 - (Use w/13154JM)
28	34178JM	+ Hose End		33712007	Split Ring - (Use w/38644040)
29	34358	+ Latch Spring	68	43414057	Furniture Nozzle
30	162329	+ Rivet	69	38617017	Crevice Tool
31	48434A	+ Latch Spring Plastic Cover	70	13149JM	Dusting Brush Connector Tube - (Use w/1 61 851 J M)
32	162345	+* Rivet	71	13150LL	+ Nozzle - (Use w/1 61851 JM)
33	21312759	+* Latch Spring Washer	72	161851JM	+ Dusting Brush
34	43468073	Hose Tube Curved		43414064	Dusting Brush (One Piece)
35	22684JM	+ Hose Assm.	73	13263BZ	+ Dusting Brush Face - (Use w/161851JM)
36	48617JM	+ Hose - Less Ends - Ultraflex			
37	13257BZ	Suction Regulator			
38	13588	+ Slide			
39	13142T	+ Suction Regulator Button			
40	13275	+* Screw			
41	34741	+ Rug Nozzle Brush Latch - 82			
42	162604	+ Rivet - 82			
43	162344	+* Screw - 82			