

Ref. No.	Part No.	Description
2	46151JM	+ Handle Shell
3	46363195	Cord
4	35380	Service Plug Assem.
5	22442Y	+ Handle Grip
6	44716	+ Handle Grip Plug
7	46853	+ Handle Hook Link
8	13008	Pad
9	12971	Switch
10	161994	+* Screw-Machine
11	23369002	+* Screw
12	23138AW	Switch Cover Plate
13	21465314	Screw
14	31969AG	Cord Protector
15	18676	Lock
16	12988AW	+* Retainer
17	12272	+ Switch Insulator & Bushing
19	12574	+ Lead Wire by Foot
20	45344	+ Screw

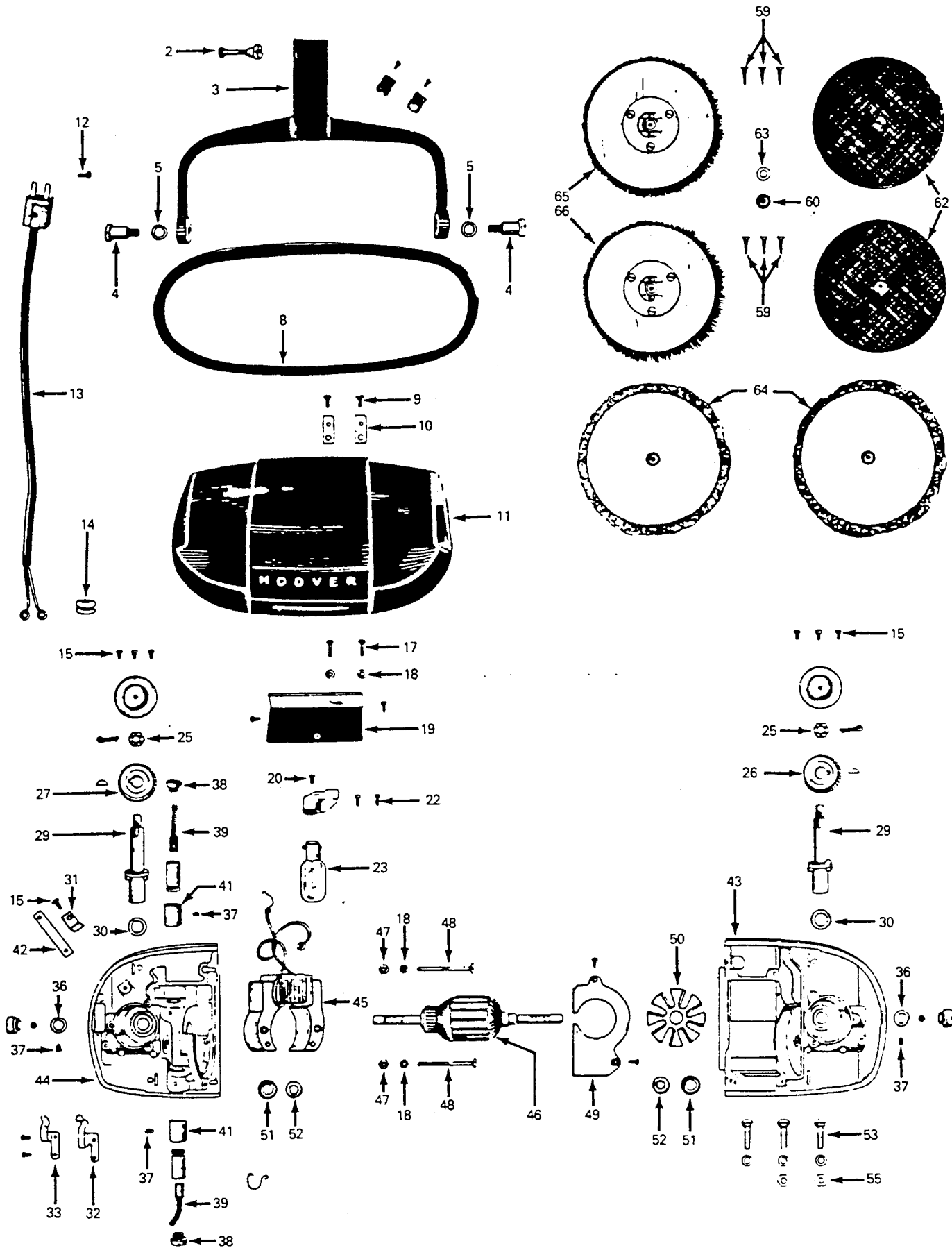

Floor Polisher

Model 021

Ref. No.	Part No.	Description	Ref. No.	Part No.	Description
2	48294AW	Handle Bolt & Nut	36	46851	+ Sealing Bushing
3	47050	+ Bail	37	162310	+* Thrust Screw - Set Screw
4	162307	+ Bail Stud	38	41027	+ Carbon Brush Holder Cap
5	162275	+* Washer	39	47025	+ Carbon Brush & Spring Assem.
8	34811	+ Furniture Guard	41	162305	+ Motor Brush Holder Insulator
9	44099	+* Hood Attach. Plate Screw	42	55298	+* Lead Wire Holder
10	45151	+ Hood Attach. Plate	43	34103	+ Housing Assem. - R.H.
11	34271	+ Motor Hood	44	34104	+ Housing Assem. - L.H.
12	21465314	* Screw	45	22432	+ Field Coil Assem.
13	34021	+ Socket Plug & Cord Assem.	46	47049	+ Armature - 110 Volts
14	162308	+ Bushing	47	14063	+* Nut
15	48963	+* Screw	48	46732	+ Field Bolt
17	162311	+* Screw - Machine	49	46734	+ Ventilating Fan Eye
18	14062	* Lock Washer	50	33948	+ Ventilating Fan
19	46752	+ Headlight Reflector	51	19231	+* Bearing and Retainer
20	45366	+* Headlight Screw	52	46804	+* Washer
22	44706	+* Screw	53	162309	+ Screw
23	42241	Bulb	55	161909	+* Nut - Hex
25	54942	+ Hex Nut	59	162306	+* Screw
26	11430	+ Worm Gear - R.H.	60	15660	* Snap - Fastener Stud
27	11431	+ Worm Gear - L.H.	62	13194	+ Polishing Pad - Felt - Pair
29	33961	+ Worm Gear Shaft Assem.	63	19772	* Washer - Lock
30	46886	+ Gear Shaft Bearing Seal	64	13198	+ High Lustre Pads - Pair
31	161534	+* Clip	65	34255	+ Polishing Brush Assem.
32	22488	+ Handle Control Detent	66	34244	+ Wax Application Brush Assem.
33	22489	+ Detent Reinforcement			