

Motor

Model 5486

Ref. No.	Part No.	Description
1	17001FW	* Screw
2	42197002	Motor Cap Assem.
3	14882	+ Motor Brush Assem.
4	13190	+* Lead Wire Holder
5	49397	+* Retainer
6	49435	+ Pin
7	45517	* Wire Holder
8	48969	Wire Nut
9	49379	+ Lead Wire Collar
10	14197	+* Terminal
11	160352	+ Field Coil
12	21312720	* Washer
13	15865	* Washer
14	49344	+* Insulator
15	23445	Armature
16	49417AZ	+* Screw
17	12165	Gear Cover Assem.
18	168404	+ Brush Gear & Shaft - L.H.
19	35674	Idler Gear - L.H.
20	35675BZ	Idler Gear - R.H.
21	168405	Brush Gear & Shaft - R.H.
22	14378	+* Screw
23	14492	Cord Clamp
24	14367	+ Cord Insulator
25	49388AY	+ Bail Shaft - R.H.
26	21312724	* Washer
27	21312757	* Washer
28	17309	Brush Carrier - R.H.

Ref. No.	Part No.	Description
29	17308	Brush Carrier - L.H.
30	160319	+ Patent Plate
31	49508	+* Screw
32	42273011	Gear Housing Comp.
33	19512AH	Switch
34	17074AG	+ Hood Adapter
35	12892	* Screw - Machine
36	14360	+ Eyelet
37	12891	Handle Control Lever Spring
38	34207AG	Foot Pad
39	12574	+ Lead Wire by Foot
40	49429	+* Screw
41	35676	+ Bail Mounting Bracket Assem.
42	21388105	+* Nut - Special
43	21312761	Washer
44	14377	+* Switch Insulator
45	38541002	Brush Gear

ITEMS NOT ILLUSTRATED

168505	+ Brush Shaft Bushing
12622	Plastic Washer Used with Bushing
168505	

Tank & Accessories

**Models 5300, 5308, 5308-01, 5471, 5477
5479, 5480, 5486, 5488, 5488-01, 5498**

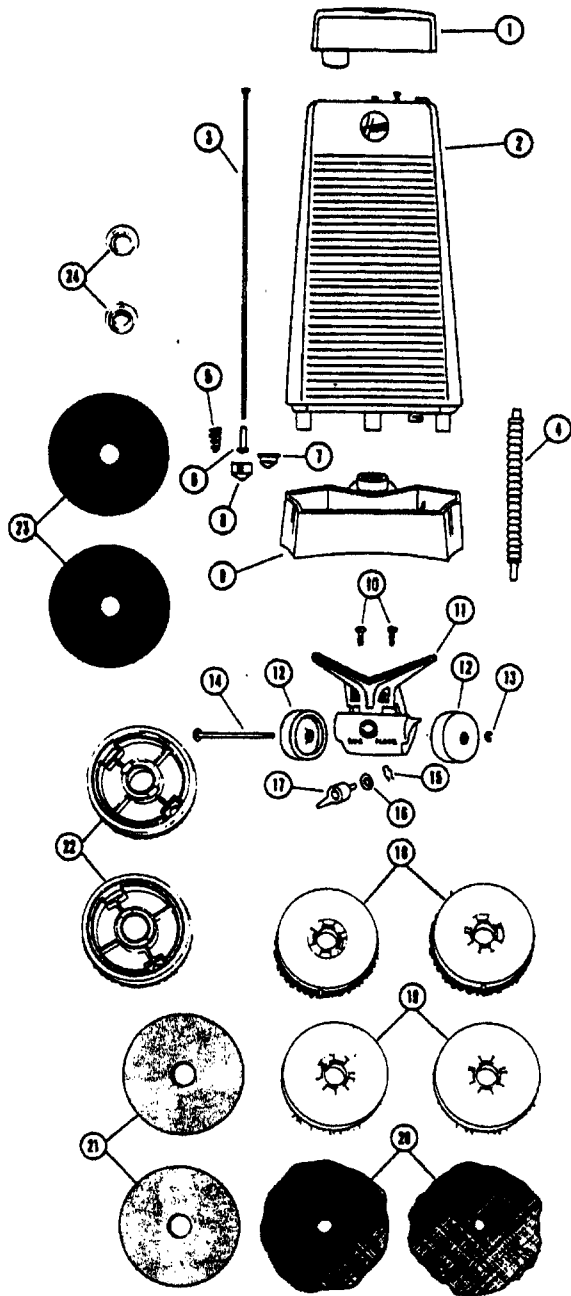

Ref.	Part Description	No.	No.
1	17084JM	Tank Cap	
2	43632028	Tank Complete	
3	19717	Valve Rod	
4	17473	Distributor Hose	
5	17314	Valve Spring	
6	14341	Valve Rod End	
7	15796	Tank Cap Liner	
8	37911006	Valve Cap	
	17083DD	+ Tank Support	
	17083JM	+ Tank Support - 5300, 5308-01	
	169421FN	+ Tank Support - 5488-01	
10	12956	* Screw	
11	18853DN	+ Wheel Carriage	
	36432017	+ Wheel Carriage & Distributor - 5308-01, 5488-01	
12	32175003	Caster Wheel	
	32175004	+ Caster Wheel - JJ	
13	13306	* Ring	
14	35662AY	+ Wheel Shaft	
15	12979	* Ring	
16	18249	+* Washer	
17	17234DD	+ Valve Body	
18	48436045	Polishing/Scrubbing Brush	
19	19619AG	+ Scrubbing Brush	
20	18360	High Lustre Pads - Pair	
21	18362	C. & W. Pads - Pair	
22	15636	Rug Shampoo Brush	
23	18361	Felt Buffing Pads - Pair	
24	15844	Pad Fastener	

ITEMS NOT ILLUSTRATED

18996	Steel Wool Pads - Pair
37911052	+ Plug - JM - 5308-01, 5488-01

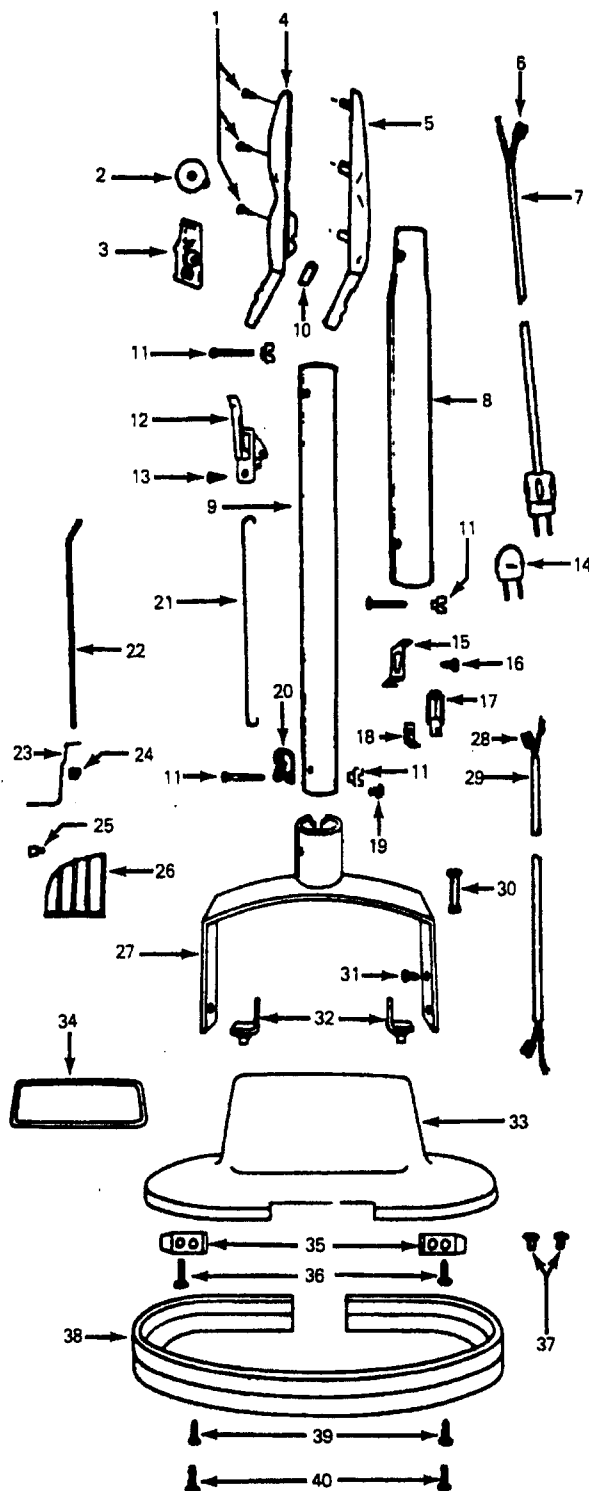

Ref. No.	Part No.	Description
1	19715	+* Screw
2	160205	+ Control Wheel
3	160213	+ Control Unit
4	161131HP	+ Handle Grip - Bottom
5	39454004	Handle Grip - Top
6	160356	* Terminal
7	46363338	Attach. Cord
8	17330JM	Handle - Lower Half
9	160204LL	+ Upper Handle
10	160201	+* Switch Pad
11	48294AW	Handle Bolt & Nut
12	160317	+ Control Housing
13	21765159	* Screw
14	35380	Service Plug Assem.
15	162069AY	+ Valve Rod Bracket
16	21465314	* Screw
17	17251	+ Cap Detent Bracket
18	18559	+ Tank Stop
19	17252	+* Rivet
20	12910	Cord Clamp
21	160202	+ Control Rod
22	162068	Control Rod - Threaded End
23	162069AY	+ Valve Control Bracket
24	162067	+ Nut
25	12763AW	* Rivet
26	161450DC	+ Tank Cap Lock
27	17348LL	+ Bail
28	161211	+* Terminal
29	160308LL	+ Motor Cord
30	14504	+ Bail Socket Insulator
31	49433	+* Screw
32	19978BG	+ Bail Arm Retainer
33	161135KK	+ Hood
34	161082	+ Nameplate
35	47779	+ Hood Attach. Plate
36	44099	+* Screw
37	49571AY	+ Rivet
38	17292JM	+ Furniture Guard
39	12738	+* Screw
40	49188	+* Screw